



**THE AIRPLANE FACTORY (Pty) Ltd**, Registration no 2002/022837/07  
Hangar 8 Tedderfield Airpark, Nettleton Road, Eikenhof, 1872, Johannesburg South  
PO Box 308, Eikenhof, 1872, South Africa. Tel: +27 (0)11 948 9898 Fax: +27(0)86 632 4493  
E-mail: sales@airplanefactory.co.za Web: www.airplanefactory.co.za

## SERVICE BULLETIN

#0004

Page 1 of 1

### The Airplane Factory (Pty) Ltd. Considers Compliance with all Service Bulletins Mandatory

**RELEASE DATE:** 19/08/2015

**EFFECTIVE DATE:** 19/08/2015

**SUBJECT:** Placement of the ELT antenna

**MODELS AFFECTED:** All Sling LSA, Sling 2, Sling Taildragger & Sling 4 aircraft where an ELT is installed

**COMPLIANCE TIME:** Next Major Periodic Inspection

**PURPOSE:** To insure the correct placement of the ELT antenna

**PARTS/EQUIPMENT LIST:**

- 1 x ELT Antenna Bracket
- 2 x 3.2 x 8mm Aluminum Rivets
- 1 x 3.3mm Drill Bit
- 1 x Drill
- 1x Cleco
- 1 x Cleco Pliers
- 1x Rivet Gun

#### INSTRUCTIONS:

If the ELT antenna is mounted in any place other than what is stipulated in this service bulletin, then this service bulletin will apply. The installation instructions illustrate the correct installation.

ITEM NO.	PART NUMBER	DESCRIPTION	QTY
1	CF-ASS-001-C-C-1	Sling 4 Centre Fuselage	1
2	RF-ASS-001-C-C-0	Sling 4 Rear Fuselage	1
3	IN-ELT-002-X-X-0	ACK ELT E-04 Whip Antenna	1
4	CF-ANG-052-X-C-0	ELT Antenna Bracket	1
5	HW-RIV-142-X-X-0	3.2 x 8mm Alu Domed Rivet	2

**Step 1**

Whilst holding part (4) below the bottom flange of the right hand seat backrest stop (as seen in assembled view) drill first 3.3mm hole and cleco, then drill second hole.

**Step 2**

Rivet part (4) with two 3.2 x 8mm Aluminium Domed Rivets into the holes drilled in step 1.

**Step 3**

Connect part (3) to part (4) by removing nut from antenna, place the antenna in place and then re-attach the nut back onto the antenna as seen in exploded view.

**Step 4**

Connect ELT to GPS on EFIS if available.

**Step 5**

Make sure ELT is programmed and registered with the SACAA. Contact The Airplane Factory for entry of battery expiry date to be made in logbook.

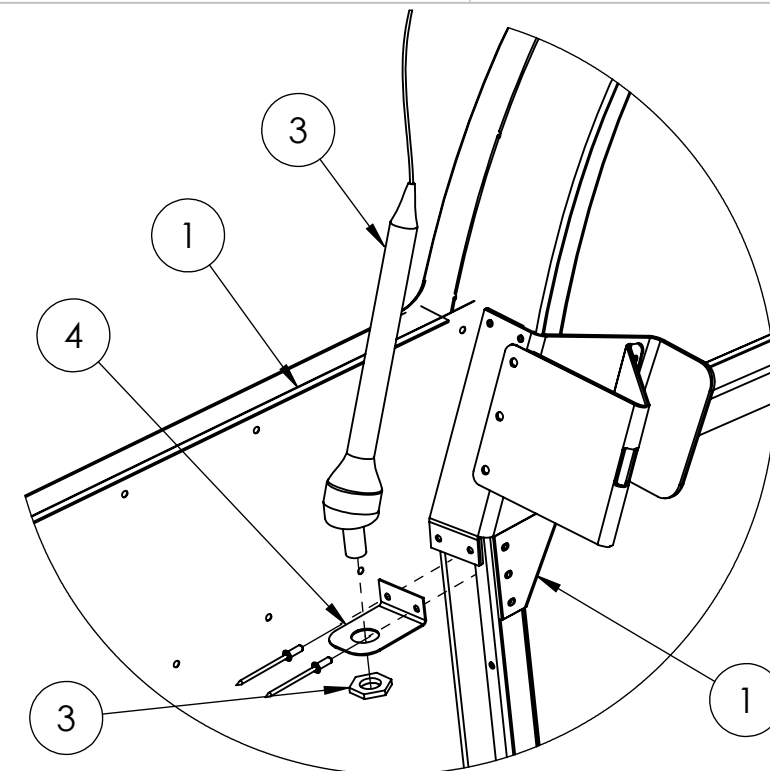
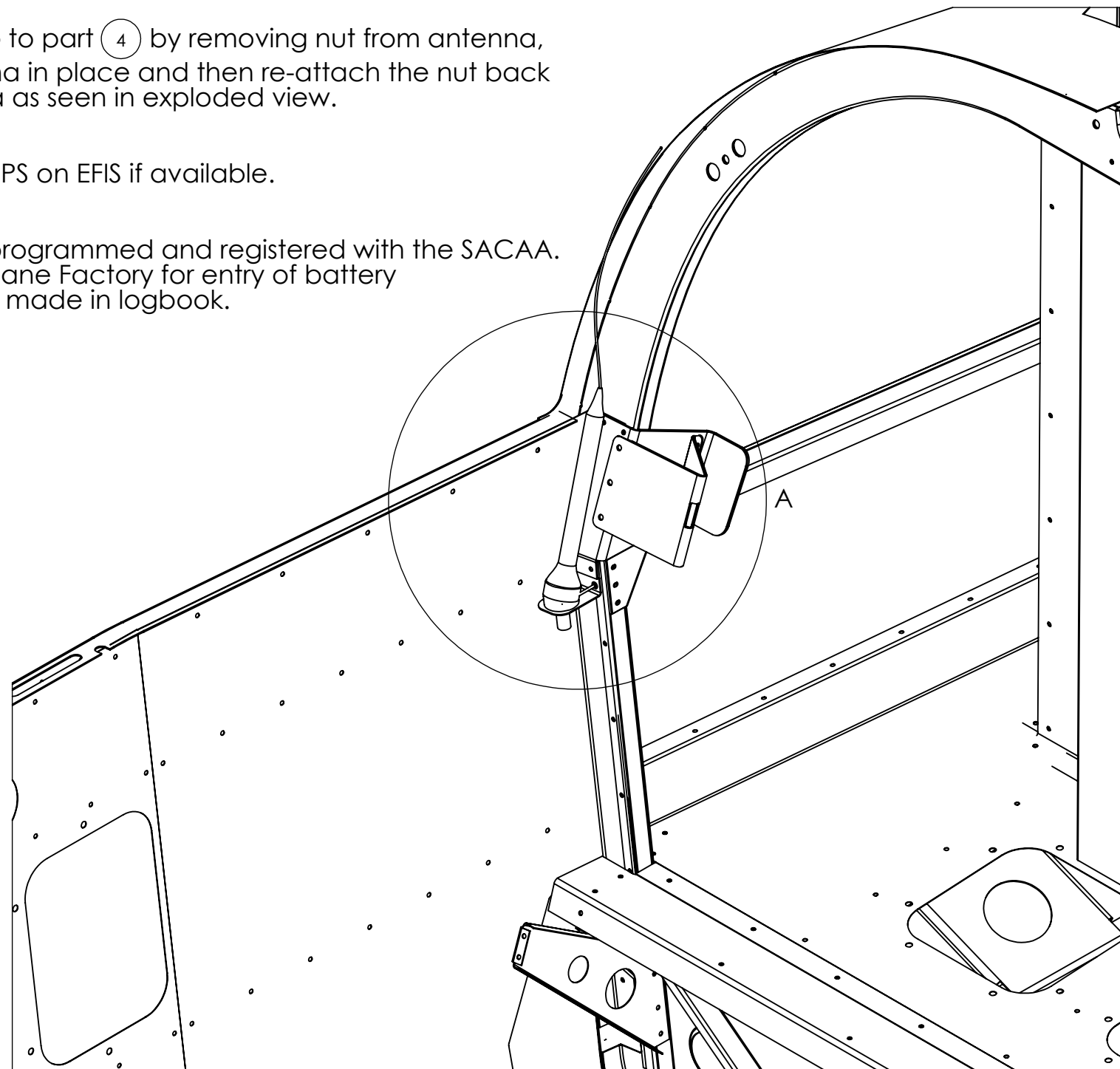

**EXPLODED VIEW**

**Note:**

The antenna will lie loose against the inside of the fuselage skin

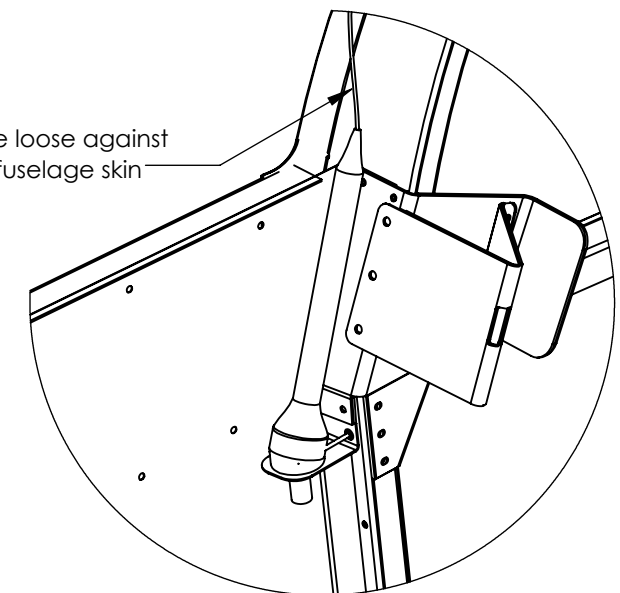

**ASSEMBLED VIEW  
(DETAIL A)**



DESCRIPTION pg 1

**ELT ANTENNA  
INSTALLATION**