



THE AIRPLANE FACTORY (Pty) Ltd
Registration no 2002/022837/07
Approved Maintenance Organisation AMO1264
Manufacturing Organisation M677

Hangar 8 Tedderfield Airpark
Nettleton Road Eikenhof
Johannesburg 1872
South Africa

PO Box 308
Eikenhof
Johannesburg 1872
South Africa

[T]+27 (0) 11 948 9898
[F]+27 (0) 86 632 4493
sales@airplaneactory.co.za
www.airplaneactory.co.za

SAFETY ALERTS

#0010

Page 1 of 3

(The Airplane Factory (Pty) Ltd. considers compliance with all Safety Alerts mandatory)

RELEASE DATE: 06/08/2019

EFFECTIVE DATE: 06/08/2019

SUBJECT: Potential risk of rudder pedal getting caught on a button head screw of the centre console when rudder is fully deflected.

MODELS AFFECTED: Sling LSA and Sling 2 aircraft fitted with rudder pedal T-pieces (Part number CT-PDL-001-L/R)

COMPLIANCE TIME: Before the next flight

LABOUR TIME: 1 hour

DESCRIPTION AND PURPOSE:

The Safety Alert provides the instructions for the rectification of rudder pedal T-pieces. This modification will prevent the rudder pedal T-piece from getting caught on a button head screw of the inspection panel cover (located on the centre console used to access the rudder stops) at full rudder deflection. The two modified T-pieces should be installed on the right pedal of the pilot side and the left pedal of the passenger side.

PARTS AND CONSUMABLES LIST:

- a) 2 x AN3 nyloc nut

TOOLS REQUIRED:

- a) 3/8" spanner
- b) Cutting tool e.g. hacksaw, angle grinder
- c) Deburring tool

INSTRUCTIONS:

1. Loosen the AN3 bolt that secures the rudder pedal T-piece to the rudder pedal so that it can be removed from the airplane.

2. Measure and mark 5 mm from along each end of the rudder pedal T-piece.
3. In a vice grip or otherwise, cut and deburr the marked ends.
4. Return the rudder pedal T-piece into the rudder pedal, install the bolt and tighten with the new AN3 nyloc nuts.
5. Ensure the new clearance, after installation, between the ends of the rudder pedal T-piece and screws of the inspection panel cover exceeds 3mm.

DIAGRAM(S):

ITEM NO.	PART NUMBER	DESCRIPTION
1	CT-PDL-002-X-A	Rudder pedal T-piece
2	HW-ANB-3112-X-X	AN3 – 12A bolt
3	HW-ANW-030-X-X	AN3 washer
4	HW-ANL-030-R-X	AN3 nyloc nut
5	CT-PDL-001-L/R	Rudder pedal

Button head screws

Inspection panel cover

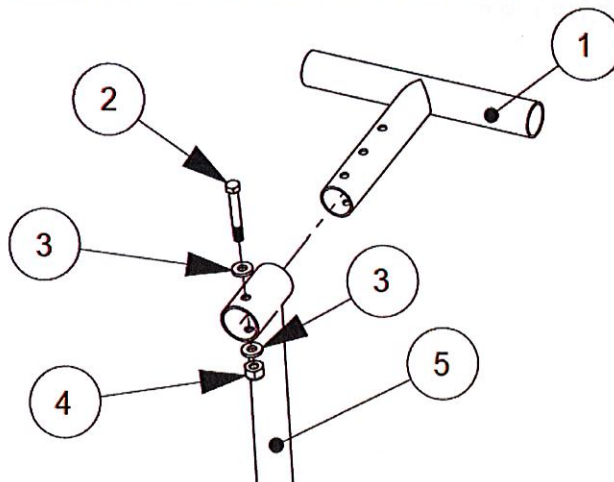
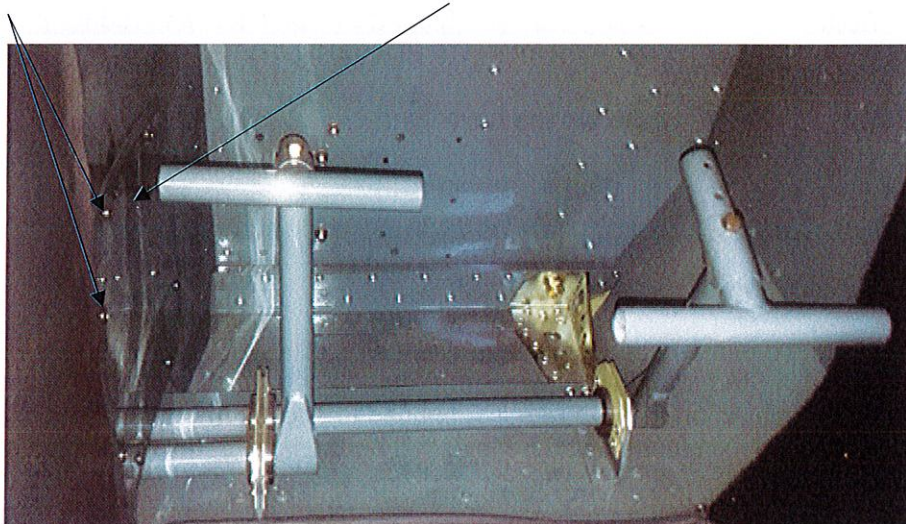

Signed on this the 7th day of August 2019



MR ANDREW PITMAN
ACCOUNTABLE MANAGER

