

**THE AIRPLANE FACTORY (Pty) Ltd**  
**Registration no 2002/022837/07**  
Approved Maintenance Organisation AMO1264  
Manufacturing Organisation M677

Hangar 8 Tedderfield Airpark  
Nettleton Road Eikenhof  
Johannesburg 1872  
South Africa

PO Box 308  
Eikenhof  
Johannesburg 1872  
South Africa

[ T ]+27 (0) 11 948 9898  
[ F ]+27 (0) 86 632 4493  
sales@airplanefactory.co.za  
www.airplanefactory.co.za

**SAFETY ALERTS**

#0010 Revision 1

Page 1 of 3

---

**(The Airplane Factory (Pty) Ltd. considers compliance with all Safety Alerts mandatory)**

**NOTE: THIS SAFETY ALERT REPLACES SAFETY ALERT #0010 (REVISION 0) IN ITS ENTIRETY**  
**SAFETY ALERT #0010 (REVISION 0) IS ACCORDINGLY CANCELLED WITH EFFECT FROM 19/08/2025.**

**RELEASE DATE:** 19/08/2025

**REASON FOR REVISION 1:** Update to list of affected models

**EFFECTIVE DATE:** 06/08/2019

**SUBJECT:** Potential risk of rudder pedal getting caught on a button head screw of the centre console when rudder is fully deflected.

**MODELS AFFECTED:** Sling LSA and Sling 2 aircraft fitted with rudder pedal T-pieces (Part number CT-PDL-001-L/R) manufactured before the effective date (06/08/2019)

**COMPLIANCE TIME:** Before the next flight

**LABOUR TIME:** 1 hour

**DESCRIPTION AND PURPOSE:**

The Safety Alert provides the instructions for the rectification of rudder pedal T-pieces. This modification will prevent the rudder pedal T-piece from getting caught on a button head screw of the inspection panel cover (located on the centre console used to access the rudder stops) at full rudder deflection. The two modified T-pieces should be installed on the right pedal of the pilot side and the left pedal of the passenger side.

**PARTS AND CONSUMABLES LIST:**

- a) 2 x AN3 nyloc nut

**TOOLS REQUIRED:**

- a) 3/8" spanner
- b) Cutting tool e.g. hacksaw, angle grinder
- c) Deburring tool

## INSTRUCTIONS:

1. Loosen the AN3 bolt that secures the rudder pedal T-piece to the rudder pedal so that it can be removed from the airplane.
2. Measure and mark 5 mm from along each end of the rudder pedal T-piece.
3. In a vice grip or otherwise, cut and deburr the marked ends.
4. Return the rudder pedal T-piece into the rudder pedal, install the bolt and tighten with the new AN3 nyloc nuts.
5. Ensure the new clearance, after installation, between the ends of the rudder pedal T-piece and screws of the inspection panel cover exceeds 3mm.

## DIAGRAM(S):

ITEM NO.	PART NUMBER	DESCRIPTION
1	CT-PDL-002-X-A	Rudder pedal T-piece
2	HW-ANB-3112-X-X	AN3 – 12A bolt
3	HW-ANW-030-X-X	AN3 washer
4	HW-ANL-030-R-X	AN3 nyloc nut
5	CT-PDL-001-L/R	Rudder pedal

Button head screws

Inspection panel cover

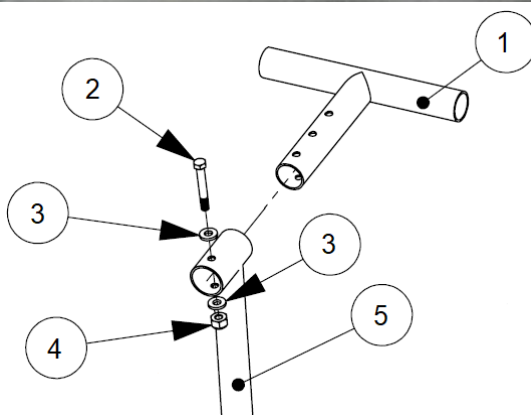

Signed on this the 19th day of August 2025

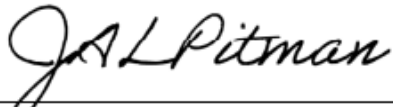
A handwritten signature in black ink that reads "JAL Pitman". The signature is written in a cursive style with a large, looped "J" and "P".

---

**ACCOUNTABLE MANAGER**

**MR JAMES PITMAN**